



FCD Series

Recessed or inground
LED with stainless
steel faceplate



Stainless

corporate
t 800 900 1730
f 630 889 8106
3609 Swenson Ave
St. Charles, IL 60174

Catalog Number

Series	Voltage	Wattage	Finish	Accessories
FCD43I FCD43P	120V - 277V	LED: 1W 3W (FCD43I) LED: 3W (FCD43P)	SS Stainless Steel	DCH Die cast well housing DP12 Distribution pattern 12° DP12x50 Distribution pattern 12° x 50° PWH PVC well housing

Product Information

Listed: UL & cUL listed for interior and exterior wet locations. IP65 rated.

Construction: Marine grade, corrosion resistant, heavy walled, high pressure die cast aluminum construction. Faceplate is 316 stainless steel. Must order well housing.

Gasket: Extruded silicone to provide maximum protection against contaminants.

Fasteners: Captive and recessed stainless steel, tamper resistant hex socket screws.

Diffuser: Lens is 3/8" thick tempered, clear (FCD43P) or opal (FCD43I) heat resistant.

LED: Integral inverter and driver potted with a variable input of voltage from 120V to 240V. Consult factory for color changing or multi-color combinations and other voltage options.

Finish: Stainless steel brushed finish.

Mounting: Concrete pour with PWH accessory.

Self-Flange

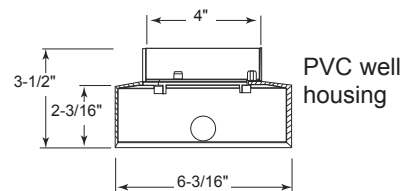
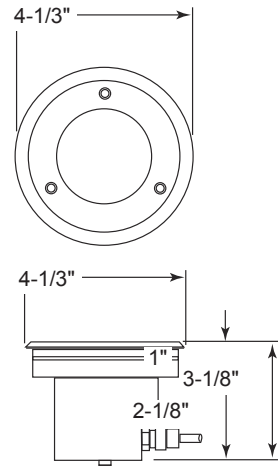

PVC well housing

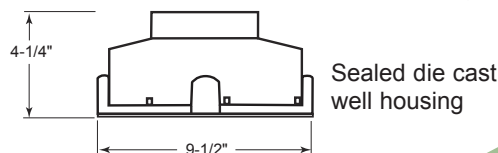

Sealed die cast well housing