



FCP662 FCP663



Date:

Type:

Luminaire:

Project:

Approved:

FCP662 and FCP663 18" Pendant light is an adjustable cable mount luminaire with die-cast aluminum shade frame over glass shade that comes in a variety of color options.



SPECIFICATIONS

PHYSICAL

dimensions	FCP662: 17.5" Ø x 11" (Shade) H + 11.5" (Canopy) H, FCP663: 17.5" Ø x 11.625" (Shade) H
weight	12 lbs
housing	marine grade, corrosion resistant, heavy gauge aluminum
shade	standard: die-cast aluminum shade frame; etched aluminum (EA) reflector with anodized etched interior; ribbed acrylic (RA)
lens	tempered glass lens with etched perimeter and clear center surface
mounting	mounts directly to standard junction box; grip-lock aviation cable supplied; adjustable cable (8"-120") standard
ingress protection	IP20, dry locations with neoprene continuous closed cell gasket to seal out contaminants
finish	Six stage cleaning and saline pre-treatment. TGIC polyester powder coat finish

PERFORMANCE

color temperature	2700K, 3000K, 3500K, 4000K
lumen output	6000 lm (FCP662 & FCP663)
lifetime	L70 > 70,000 hours
color consistency	3 SDCM, 85 or 90 CRI
operating temperature	-13°F to 104°F (-25°C to 40°C)
junction temperature	73°C @ T _A 25°C
warranty	5-Year limited warranty (refer to website for details)

ELECTRICAL

input voltage	Universal 120-277 VAC, optional: 347 VAC (integral)
power supply	integral Class II, electronic high-power factor > 94% @120V
certifications	ETL / cETL Listed, CEC Title 24 JA8 compliant (only 90 CRI)
standards	UL1598, CSA C22.2 No. 250.0, UI 8750, CSA C22.2 No. 250.13, IES LM-79/LM-80
power consumption	66W @ 6000 lm (maximum)
dimming	LD 0-10V Dimming (1%)

Due to continuous development and improvements, specifications are subject to change without notice. FC Lighting reserves the right to change lab test details or specifications without notice. Product use certifies agreement to FC Lighting terms and conditions.

Ordering Information



ORDERING INFORMATION

Example: FCP662-UNV-4K-CRI85-60L-TG-RA-LD

FCP662				60L						
SERIES	VOLTAGE	CCT	CRI	LUMENS	FINISH	SHADE COLOR	OPTIONS			
FCP662	UNV	UNV 120V-277V	27K	2700K	CRI85	85 CRI	60L 6000 lm (66W)	CC Custom Color	EA Etched Aluminum	LD 0-10V Dimming, 1%
	347V	347V (remote)	3K	3000K	CRI90	90 CRI		TG Textured Gray	RA Ribbed Acrylic	
			35K	3500K						
			4K	4000K						

REMOTE DRIVER & BATTERY BACKUP

FCP662R													
Series	Voltage		CCT		CRI		Lumens	Finish		Shade Color		Options	
FCP662R ¹	UNV	UNV 120V-277V	27K	2700K	CRI85	85 CRI	60L 6000 lm (66W)	CC	Custom Color	EA	Etched Aluminum	LD	0-10V Dimming, 1%
			3K	3000K	CRI90	90 CRI		TG	Textured Gray	RA	Ribbed Acrylic	BBUR ¹	Battery Backup Remote (Indoor)
			35K	3500K								N/A	Leave Blank for Remote Driver Only (without Battery Backup)
			4K	4000K									

[†] LED DRIVER REMOTE (INDOOR) IP20, IK08, NEMA 1, -20°C to +50°C, 30' MAX Distance with 12AWG.

*Consult factory for outdoor remote driver only.

[‡] Battery Back-up & LED Driver Remote (INDOOR), IP20, IK08, NEMA 1, 0°C to +48°C, 30' MAX Distance with 12AWG (w/UNV Option Only)

FCP663								
Series	Voltage	CCT	CRI	LUMENS	Finish	Shade Color	Options	
FCP663	UNV	UNV 120V-277V	27K 2700K	CRI85 85 CRI	60L 6000 lm (66W)	CC Custom Color	EA Etched Aluminum	LD 0-10V Dimming
	347V	347V (remote)	3K 3000K	CRI90 90 CRI		TG Textured Gray	RA Ribbed Acrylic	
			35K 3500K					
			4K 4000K					

REMOTE DRIVER & BATTERY BACKUP

FCP662R													
Series	Voltage		CCT		CRI		Lumens	Finish		Shade Color		Options	
FCP662R ¹	UNV	UNV 120V-277V	27K	2700K	CRI85	85 CRI	60L 6000 lm (66W)	CC	Custom Color	EA	Etched Aluminum	LD	0-10V Dimming, 1%
			3K	3000K	CRI90	90 CRI		TG	Textured Gray	RA	Ribbed Acrylic	BBUR ¹	Battery Backup Remote (Indoor)
			35K	3500K								N/A	Leave Blank for Remote Driver Only (without Battery Backup)
			4K	4000K									

[†] LED DRIVER REMOTE (INDOOR) IP20, IK08, NEMA 1, -20°C to +50°C, 30' MAX Distance with 12AWG.

*Consult factory for outdoor remote driver only.

[‡] Battery Back-up & LED Driver Remote (INDOOR), IP20, IK08, NEMA 1, 0°C to +48°C, 30' MAX Distance with 12AWG (w/UNV Option Only)

Consult Factory for other options and configurations.

To ensure you receive proper configurations for your lighting specifications, contact us directly about any unique application requirements. This may include but not be limited to lumen output, mounting needs, or electrical requirements.

Due to continuous development and improvements, specifications are subject to change without notice. FC Lighting reserves the right to change lab test details or specifications without notice. Product use certifies agreement to FC Lighting terms and conditions.

Dimensions



PRODUCT DIMENSIONS - FCP662 STANDARD PRODUCT

width	Ø 17.5"
height (shade)	11" H
height (housing)	15" H
height (canopy)	1.25" H

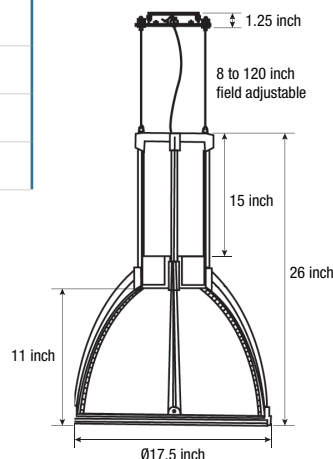

MOUNTING FCP662 - j-box sold by others

mounting plate width	4.5" W
----------------------	--------

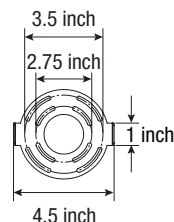

3.5" or 2.75" mounting diameter

j-box mounting plate:
mounts flush to surface
and is included
with luminaire

PRODUCT DIMENSIONS - FCP663 STANDARD PRODUCT

width	Ø 17.5"
height (shade)	11" H
height (housing)	11.63" H
height (canopy)	3.8" H

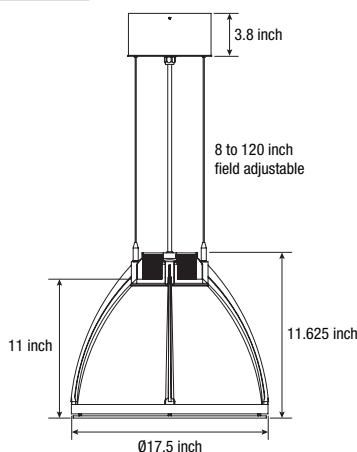

MOUNTING FCP663 - j-box sold by others

mounting plate width	7" W
----------------------	------

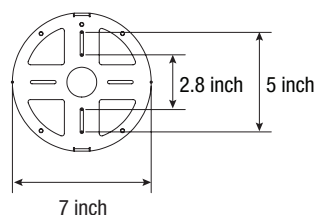

2.8" to 5" mounting diameter

j-box mounting plate:
mounts flush to surface
and is included
with luminaire

Due to continuous development and improvements, specifications are subject to change without notice. FC Lighting reserves the right to change lab test details or specifications without notice. Product use certifies agreement to FC Lighting terms and conditions.

Battery Backup



BBUR — Battery Backup & LED Driver Remote (Indoor), IP20, IK08, NEMA 1, 0 to 48 °C (32 to 118 °F), 30 feet Maximum Distance with 12 AWG (with UNV Option Only)

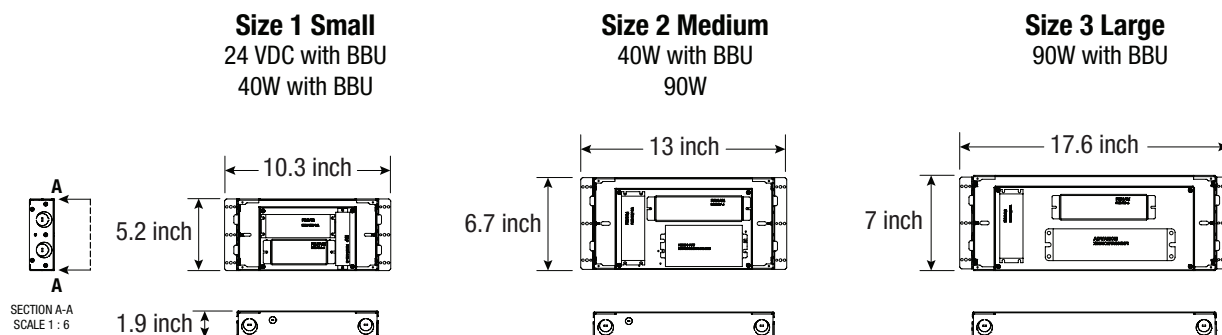

BBUX — Battery Backup & LED Driver Remote (Outdoor), IP67, IK10, NEMA 4X, -20 to 55 °C (-4 to 131 °F), 30 feet Maximum Distance with 12AWG (with UNV Option Only)

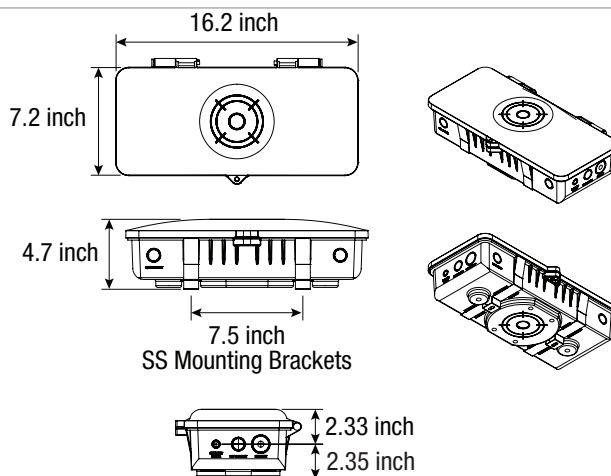

Due to continuous development and improvements, specifications are subject to change without notice. FC Lighting reserves the right to change lab test details or specifications without notice. Product use certifies agreement to FC Lighting terms and conditions.



US Commercial Lighting Manufacturer Since 1982

Specification Sheet