

FC
OUTDOOR LIGHTING
FCSL103



ADA



Date:

Type:

Fixture:

Project:

Approved:

FCSL103 IP65 rated exterior die-cast brick step light with vertical louvers for masonry applications. Corrosion resistant, die-cast aluminum construction, this fixture provides illumination for damp, dry or wet areas.

SPECIFICATIONS

PHYSICAL

| | |
|--------------------|--------------------------------------------------------------------------------------------------------------------------------------------------------------------------------------------|
| dimensions | 2.8" W x 3.22" H x 3.34" Deep (Faceplate with Backbox) |
| weight | 2 lbs |
| housing | Marine grade, corrosion resistant, heavy gauge aluminum, louvered faceplate |
| lens | White glass lens |
| mounting | Concrete pour, masonry applications |
| ingress protection | IP65 : dry, damp or wet locations with extruded silicone gasket to seal out contaminants |
| faceplate finish | Six stage chemical iron phosphate conversion pre-treatment. Polyester powder coat finish, 18 µm Min., 5000hr salt spray test (ASTM B117) compliant with Florida / AAMA 2604 specification. |

PERFORMANCE

| | | | | |
|-----------------------|--------------------------------------------------------|-------|-------|-------|
| color temperature | 2700K | 3000K | 3500K | 4000K |
| lumen output | 250 lm | | | |
| lifetime | > 70,000 hours / L70 or better | | | |
| color consistency | 3 SDCM / 85 CRI | | | |
| operating temperature | -13°F to 104°F (-25°C to 40°C) | | | |
| junction temperature | 73°C @ T ^A 25°C | | | |
| warranty | 5-Year limited warranty (refer to website for details) | | | |

ELECTRICAL

| | |
|-------------------|----------------------------------------------------------------------------------|
| input voltage | Universal 120 - 277 VAC |
| power supply | Integral Class II, electronic high-power factor > 94% @ 120V |
| certifications | ETL / cETL Listed ADA compliant |
| standards | UL1598 / CSA C22.2 No. 250.0; UL 8750 / CSA C22.2 No. 250.13 / IES LM-79 / LM-80 |
| power consumption | 10W @ 120 - 277 VAC |
| dimming | 0-10V (10%) |

Due to continuous development and improvements, specifications are subject to change without notice. FC Lighting reserves the right to change lab test details or specifications without notice. Product use certifies agreement to FC terms and conditions.



US Commercial Lighting Manufacturer Since 1982

© FC Lighting

3609 Swenson Ave. • St. Charles, IL • 60174 | fcighting.com | 800.900.1730

Specification Sheet

JC-DM-111225

Ordering Information



ORDERING INFORMATION

| FCSL103 | | | | | | | 2L | | | | | |
|---------|---------|---------------|-----|-------|-------|--------|--------|--------------|--------|---------------|---------|------------------------------------------------------|
| SERIES | VOLTAGE | | CCT | | CRI | | LUMENS | | FINISH | | OPTIONS | |
| FCSL103 | 120V | 120 VAC | 27K | 2700K | CRI85 | 85 CRI | 2L | 250 lm (10W) | BKE | Black | LD | LED Dimming (0-10V) (Standard) |
| | 277V | 277 VAC | 3K | 3000K | | | | | BRE | Bronze | HB | Hanger Bracket |
| | UNV | 120 - 277 VAC | 35K | 3500K | | | | | GRE | Graphite Grey | LBB | Less Back Box (for shipment separate of Back Box) |
| | | | 4K | 4000K | | | | | SLE | Silver | | |
| | | | | | | | | | WHE | White | | |
| | | | | | | | | | CCE | Custom Color | | |
| | | | | | | | | | | | | |
| | | | | | | | | | | | | |

BACK BOX KITS

H99001-ETL Back Box Kit - Complete Back Box shipped in advance of fixture without mounting kit.

Consult Factory for other options and configurations.

To ensure you receive proper configurations for your lighting specifications, contact us directly about any unique application requirements. This may include but not be limited to lumen output, mounting needs, or electrical requirements.

Due to continuous development and improvements, specifications are subject to change without notice. FC Lighting reserves the right to change lab test details or specifications without notice. Product use certifies agreement to FC terms and conditions.

 US Commercial Lighting Manufacturer Since 1982

© FC Lighting 3609 Swenson Ave. • St. Charles, IL • 60174 | fcighting.com | 800.900.1730

Specification Sheet

JC-DM-111225



Dimensions

PRODUCT DIMENSIONS - STANDARD PRODUCT

| | |
|--------|---------|
| width | 9.44" W |
| height | 2.8" H |
| depth | 3" D |

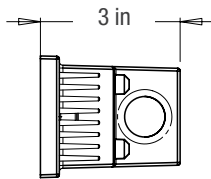
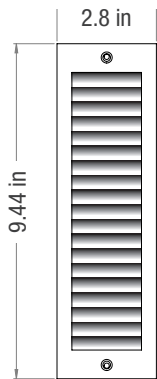

MOUNTING - *j-box sold by others*

| | |
|-----------------|----------|
| back box width | 9.375" W |
| back box height | 2.64" H |
| back box depth | 3" D |

back box mounts inside brick masonry: faceplate flush to surface or in front of surface - see installation instructions for proper mounting directions

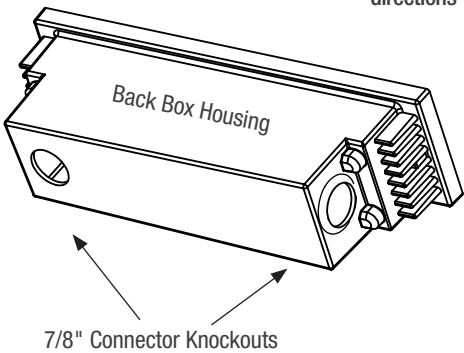

Due to continuous development and improvements, specifications are subject to change without notice. FC Lighting reserves the right to change lab test details or specifications without notice. Product use certifies agreement to FC terms and conditions.



US Commercial Lighting Manufacturer Since 1982

Photometry



OPTICAL DISTRIBUTION

| | |
|-------------------|----------------|
| lumen output | 254 Lm @ 4000K |
| power consumption | 10W |

| Illuminance at a Distance | | | |
|---------------------------|----------------|------------|--------|
| | Center Beam fc | Beam Width | |
| 1.7ft | 20.8 fc | 0.2 ft | 0.9 ft |
| 3.3ft | 5.53 fc | 0.4 ft | 1.8 ft |
| 5.0ft | 2.41 fc | 0.6 ft | 2.8 ft |
| 6.7ft | 1.34 fc | 0.8 ft | 3.7 ft |
| 8.3ft | 0.87 fc | 1.0 ft | 4.6 ft |
| 10.0ft | 0.60 fc | 1.3 ft | 5.6 ft |

■ Vert. Spread: 7.2°
■ Horiz. Spread: 31.1°

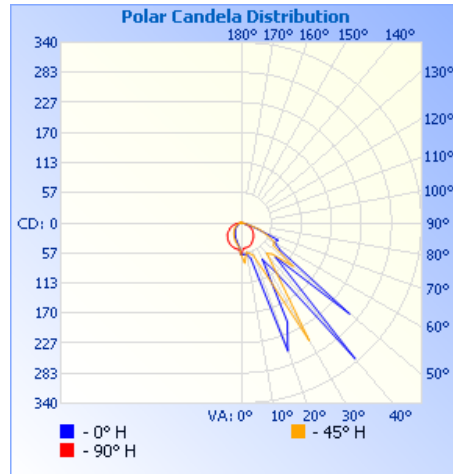

iti illuminations testing laboratory : Report #2038

Due to continuous development and improvements, specifications are subject to change without notice. FC Lighting reserves the right to change lab test details or specifications without notice. Product use certifies agreement to FC terms and conditions.

 US Commercial Lighting Manufacturer Since 1982

© FC Lighting 3609 Swenson Ave. • St. Charles, IL • 60174 | fcighting.com | 800.900.1730

Specification Sheet

JC-DM-111225