

FCW3162



Date:

Type:

Luminaire:

Project:

Approved:

FCW3162 Exterior Decor oval luminaire with eyelid face is a die-cast aluminum ceiling or wall mount luminaire and is IP65 rated. This ADA compliant, easy to install luminaire has an impact resistant lens and provides ample lighting for ceiling, wall or surface mounting. Face options available in this family of luminaires with finish and color temperature options to specify a wide variety of applications.



SPECIFICATIONS

PHYSICAL

dimensions	8.26" H x 13.4" W x 4.25" D
weight	3.5 lbs
housing	Marine grade, corrosion resistant, heavy gauge high pressure die-cast aluminum; captive stainless steel tamper resistant hex head socket screws
lens	Impact and vandal resistant, UV stabilized, white opal, polycarbonate
mounting	Masonry applications use four (4) 0.25" x 0.75" screws with lead anchors (fasteners not included, j-box by others)
ingress protection	IP65 Rated. Suitable for wet, damp or dry location application, with extruded silicone gasket to seal out contaminants
finish	Available in Black, Bronze, Graphite Grey, Silver, White and Custom Colors. Six stage chemical iron phosphate conversion pre-treatment. Polyester powder coat finish, 18 µm minimum thickness, 5,000 hours salt spray test (ASTM B117) compliant with Florida, AAMA 2604 specification.

PERFORMANCE

color temperature	2700K, 3000K, 3500K, 4000K
lumen output	1030 lm, 1500 lm, 2100 lm, 4300 lm
lifetime	L70 >70,000 hours
color consistency	3 SDCM / Standard: 85 CRI, Optional: 90 CRI
operating temperature	-13°F to 104°F (-25°C to 40°C)
junction temperature	73°C @ T ^a 25°C
warranty	5-Year limited warranty

ELECTRICAL

input voltage	Universal 120 - 277 VAC Optional: 347 VAC (Remote)
power supply	Integral Class II, electronic high-power factor > 94% @ 120V
certifications	ETL/cETL Listed, CEC Title 24 JA8 compliant (only 90CRI complies), ADA Compliant
standards	UL 1598, CSA C22.2 No. 250.0, UL 8750, CSA C22.2 No. 250.13 - Class II, IES LM-79 / LM-80
power consumption	61W @ 120V (Maximum)
dimming interface	Standard: 0-10V (1%) Optional: ELV (120V Only) / DMX (Remote) / DALI (Remote)

Due to continuous development and improvements, specifications are subject to change without notice. FC Lighting reserves the right to change lab test details or specifications without notice. Product use certifies agreement to FC Lighting terms and conditions. FCC Series Cylinder Lights are engineered and produced in our Illinois manufacturing facility.



Ordering Information

ORDERING INFORMATION

FCW3162										
SERIES	VOLTAGE		CCT		CRI		LUMENS		FINISH	
FCW3162	UNV	120 - 277 VAC	27K	2700K	CRI85	85 CRI (Standard)	11L	1030 lm (15W)	BKE	Black
	120V	120 VAC	3K	3000K	CRI90	90 CRI	15L	1500 lm (22W)	BRE	Bronze
	347V	347 VAC (Remote)	35K	3500K			21L	2100 lm (30.5W)	GRE	Graphite Grey
			4K	4000K			43L	4300 lm (61W)	SLE	Silver
									WHE	White
									CCE	Custom Color
									LD	0-10V Dimming (10%)
									ELV*	ELV Dimming (120 VAC Only)
									DMX	DMX Dimming (Integral)
									DALI	DALI Dimming (Integral)

REMOTE DRIVER & BATTERY BACKUP

FCW3162R										
SERIES	VOLTAGE		CCT		CRI		LUMENS		FINISH	
FCW3162R†	UNV	120 - 277 VAC	27K	2700K	CRI85	85 CRI (Standard)	11L	1030 lm (15W)	BKE	Black
			3K	3000K	CRI90	90 CRI	15L	1500 lm (22W)	BRE	Bronze
			35K	3500K			21L	2100 lm (30.5W)	GRE	Graphite Grey
			4K	4000K			43L	4300 lm (61W)	SLE	Silver
									WHE	White
									CCE	Custom Color
									LD	0-10V Dimming (10%)
									DMX	DMX Dimming (Remote Only)
									DALI	DALI Dimming (Remote Only)
									BBUR ¹	Battery Backup Remote (Indoor)
									BBUX ²	Battery Backup Remote (Outdoor)
									DRR ¹	LED Driver Only Remote (Indoor)
									DRX ²	LED Driver Only Remote (Outdoor)

† LED DRIVER REMOTE (INDOOR) IP20, IK08, NEMA 1, -20°C to +50°C, 30' MAX Distance with 12AWG.

*Consult factory for outdoor remote driver only.

¹ Battery Back-up & LED Driver Remote (Indoor), IP20, IK08, NEMA 1, 0° to 48°C (32° to 118°F), 30 FT Maximum Distance with 12AWG (with UNV Option Only), 500 Lumens Nominal (with UNV Option Only)

² Battery Back-up & LED Driver Remote (Outdoor), IP67, IK10, NEMA 4X, -20 to 55°C (-4 to 131°F), 30 FT Maximum Distance with 12AWG (with UNV Option Only), 600 Lumens Nominal

Due to continuous development and improvements, specifications are subject to change without notice. FC Lighting reserves the right to change lab test details or specifications without notice. Product use certifies agreement to FC Lighting terms and conditions. FCC Series Cylinder Lights are engineered and produced in our Illinois manufacturing facility.



Dimensions

PRODUCT DIMENSIONS - STANDARD PRODUCT

height	8.26" W
width	13.4" H
depth	4.25" D

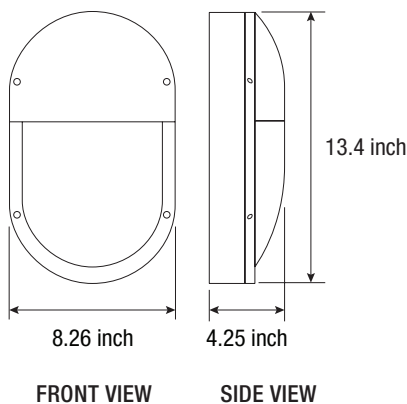

MOUNTING - *j-box sold by others*

mounting plate width	8" W
mounting diameter	2.75" or 3.5"

8 inch mounting plate: mounts flush to surface, included with luminaire

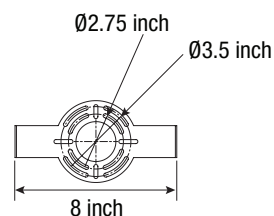

Due to continuous development and improvements, specifications are subject to change without notice. FC Lighting reserves the right to change lab test details or specifications without notice. Product use certifies agreement to FC Lighting terms and conditions. FCC Series Cylinder Lights are engineered and produced in our Illinois manufacturing facility.



Photometry

OPTICAL DISTRIBUTION

lumen output	4300 lm @ 4000K
power consumption	61W

Illuminance at a Distance			
	Center Beam fc	Beam Width	
1.7ft	30.6 fc	4.1 ft	1.5 ft
3.3ft	8.12 fc	8.0 ft	2.9 ft
5.0ft	3.54 fc	12.1 ft	4.5 ft
6.7ft	1.97 fc	16.2 ft	6.0 ft
8.3ft	1.28 fc	20.1 ft	7.4 ft
10.0ft	0.88 fc	24.2 ft	8.9 ft

■ Vert. Spread: 100.9°
■ Horiz. Spread: 48.2°

illuminations testing laboratory :

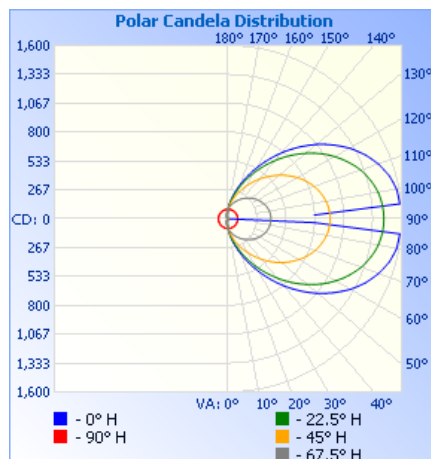

FCW3162

FIND IES FILES ON FCLIGHTING.COM

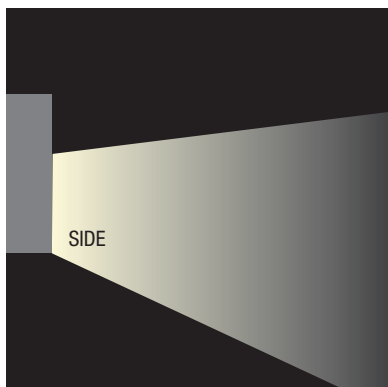

Due to continuous development and improvements, specifications are subject to change without notice. FC Lighting reserves the right to change lab test details or specifications without notice. Product use certifies agreement to FC Lighting terms and conditions. FCC Series Cylinder Lights are engineered and produced in our Illinois manufacturing facility.

 US Commercial Lighting Manufacturer Since 1982

Specification Sheet



Battery Backups

BBUR — Battery Backup & LED Driver Remote (Indoor), IP20, IK08, NEMA 1, 0 to 48 °C (32 to 118 °F), 30 feet Maximum Distance with 12 AWG (with UNV Option Only)

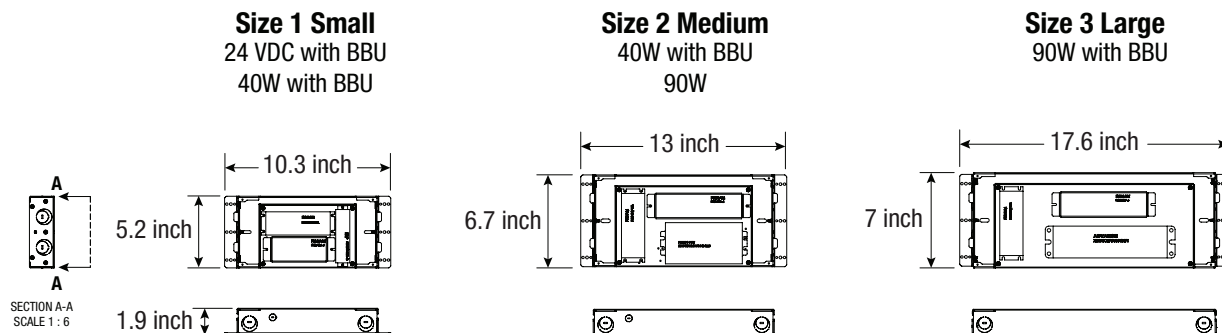

BBUX — Battery Backup & LED Driver Remote (Outdoor), IP67, IK10, NEMA 4X, -20 to 55 °C (-4 to 131 °F), 30 feet Maximum Distance with 12AWG (with UNV Option Only)

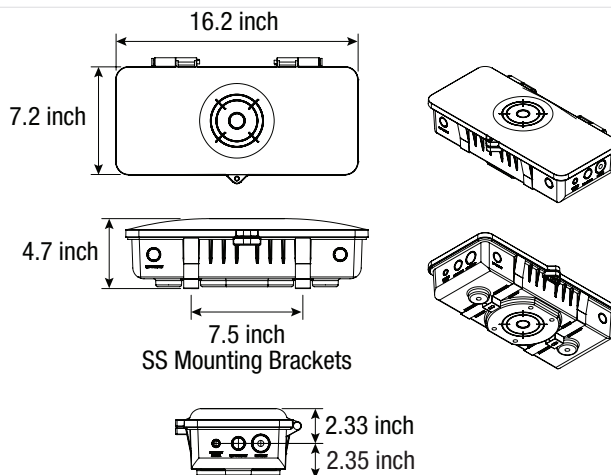

Due to continuous development and improvements, specifications are subject to change without notice. FC Lighting reserves the right to change lab test details or specifications without notice. Product use certifies agreement to FC Lighting terms and conditions. FCC Series Cylinder Lights are engineered and produced in our Illinois manufacturing facility.