

FCW1029

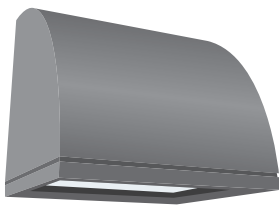

Date:

Type:

Fixture:

Project:

Approved:

FCW1029 Architectural pyramid design, Directional Wall fixture is a functional IP65 rated down light. Corrosion resistant, extruded aluminum construction, this fixture provides ample illumination for damp, dry or wet areas.

SPECIFICATIONS

PHYSICAL

beam patterns	Spot Narrow Flood Flood Wide Flood Ellipsoidal (12 x 40) Asymmetric
dimensions	12" W x 12" H x 12" D
weight	10 lbs
housing	Marine grade, corrosion resistant, heavy gauge aluminum
lens	Standard: 1/8" thick, clear tempered glass lens Optional: polycarbonate lens
mounting	Mounts directly to standard junction box; masonry applications use four (4) 0.25" x 0.75" screws with lead anchors (fasteners not included, j-box by others) Optional: adjustable arm (15° tilt)
ingress protection	IP65 : dry, damp or wet locations with extruded silicone gasket to seal out contaminants
finish	Six stage chemical iron phosphate conversion pre-treatment. Polyester powder coat finish, 18 µm Min., 5000hr salt spray test (ASTM B117) compliant with Florida / AAMA 2604 specification.

PERFORMANCE

color temperature	2700K	3000K	3500K	4000K	
lumen output	1000 lm	1500 lm	2000 lm	2500 lm	3000 lm
lifetime	> 70,000 hours / L70 or better				
color consistency	3 SDCM / standard: 85 CRI optional: 90 CRI				
operating temperature	-13°F to 104°F (-25°C to 40°C)				
junction temperature	73°C @ T ^A 25°C				
warranty	5-Year limited warranty (refer to website for details)				

ELECTRICAL

input voltage	Universal 120 - 277 VAC optional: 347 VAC (integral)
power supply	Integral Class II, electronic, high power factor > 94% @ 120V
certifications	ETL/cETL Listed, CEC Title 24 JA8 compliant (only 90CRI qualifies)
standards	UL1598/CSA C22.2 No. 250.0; UI 8750/CSA C22.2 No. 250.13/IES LM-79/LM-80
power consumption	40W @ 120 - 277 VAC
dimming	standard: 0-10V (1%) optional: ELV (120V Only) / DMX (Integral) / DALI (Integral)

Due to continuous development and improvements, specifications are subject to change without notice. FC Lighting reserves the right to change lab test details or specifications without notice. Product use certifies agreement to FC Lighting terms and conditions. FCC Series Cylinder Lights are engineered and produced in our Illinois manufacturing facility.



US Commercial Lighting Manufacturer Since 1982

Specification Sheet

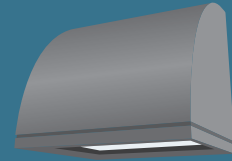

Ordering Information

ORDERING INFORMATION

FCW1029																				
Series		Voltage		CCT		LUMENS		CRI		Finish		Optics		Options						
FCW1029	UNV	120 - 277 VAC		27K	2700K	CRI85	85 CRI (Standard)		10L	1000 lm (13W)		BKE	Black		SP	Spot	LD	0-10V Dimming (1%) (Standard)		
	120V	120 VAC		3K	3000K	CRI90	90 CRI		15L	1500 lm (20W)		BRE	Bronze		NFL	Narrow Flood		ELV*	ELV Dimming *(120V Only)	
	347V	347 VAC (Integral)		35K	3500K				20L	2000 lm (27W)		GRE	Graphite Grey		FL	Flood		DMX	DMX Dimming (Integral)	
				4K	4000K				25L	2500 lm (34W)		SLE	Silver		WFL	Wide Flood		DALI	DALI Dimming (Integral)	
									30L	3000 lm (40W)		WHE	White		1240	12"x40" Ellipsoidal		PCL	Polycarbonate Lens	
												CCE	Custom Color		ASYM	Asymmetrical		ADJ	Adjustable Arm, 15° tilt	
																	BBUR	Battery Backup, Remote		

REMOTE DRIVER & BATTERY BACKUP

FCW1029R		UNV													
Series		Voltage		CCT		CRI		LUMENS		Finish		Optics		Options	
FCW1029R†	UNV	120 - 277 VAC	27K	2700K	CRI85	85 CRI (Standard)	10L	1000 lm (13W)	BKE	Black	SP	Spot	LD	0-10V Dimming (1%) (Standard)	
			3K	3000K	CRI90	90 CRI	15L	1500 lm (20W)	BRE	Bronze	NFL	Narrow Flood	DMX	DMX Dimming (Remote)	
			35K	3500K			20L	2000 lm (27W)	GRE	Graphite Grey	FL	Flood	DALI	DALI Dimming (Remote)	
			4K	4000K			25L	2500 lm (34W)	SLE	Silver	WFL	Wide Flood	PCL	Polycarbonate Lens	
							30L	3000 lm (40W)	WHE	White	1240	12"x40° Ellipsoidal	ADJ	Adjustable Arm, 15° tilt	
									CCE	Custom Color	ASYM	Asymmetrical	BBUR¹	Battery Backup Remote (Indoor)	
													BBUX²	Battery Backup Remote (Outdoor)	
													N/A	Leave Blank for Remote Driver Only (without Battery Backup)	

† LED DRIVER REMOTE (INDOOR) IP20, IK08, NEMA 1, -20°C to +50°C, 30' MAX Distance with 12AWG.

* Consult factory for outdoor remote driver only.

[†] LED DRIVER REMOTE (INDOOR) IP20, IK08, NEMA 1, -20°C to +50°C, 30' MAX Distance with 12AWG.

*Consult factory for outdoor remote driver only.

¹ Battery Back-up & LED Driver Remote (INDOOR), IP20, IK08, NEMA 1, 0°C to +48°C, 30' MAX Distance with 12AWG (w/UNV Option Only)

² Battery Back-up & LED Driver Remote (OUTDOOR), IP67, IK10, NEMA 4X, -20°C to +55°C, 30' MAX Distance with 12AWG (w/UNV Option Only)

Due to continuous development and improvements, specifications are subject to change without notice. FC Lighting reserves the right to change lab test details or specifications without notice. Product use certifies agreement to FC Lighting terms and conditions. FCC Series Cylinder Lights are engineered and produced in our Illinois manufacturing facility.



US Commercial Lighting Manufacturer Since 1982

Specification Sheet

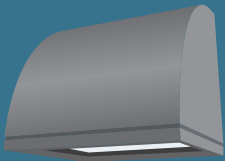

Dimensions

PRODUCT DIMENSIONS - STANDARD PRODUCT

width	12" W
height	12.06" H
depth	12.06" D

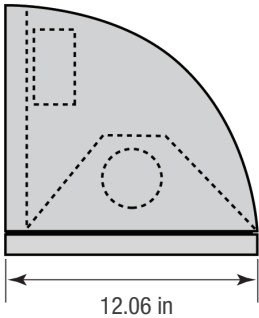
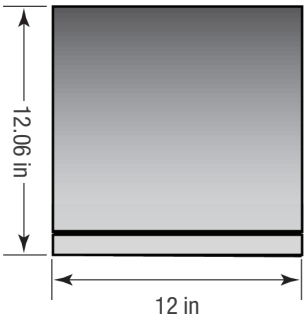

MOUNTING - *j-box sold by others*

mounting cleat width	4" W
mounting cleat height	10" H

mounting cleat:
mounts flush to j-box
surface and is included
with fixture

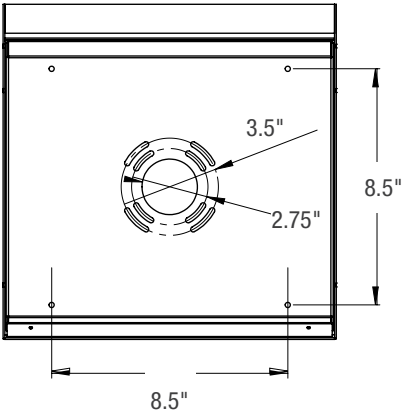

3.5" or 2.75" mounting diameter

Due to continuous development and improvements, specifications are subject to change without notice. FC Lighting reserves the right to change lab test details or specifications without notice. Product use certifies agreement to FC Lighting terms and conditions. FCC Series Cylinder Lights are engineered and produced in our Illinois manufacturing facility.



US Commercial Lighting Manufacturer Since 1982

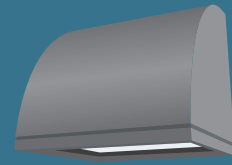

Photometry

FCW1029

FIND IES FILES ON FCLIGHTING.COM

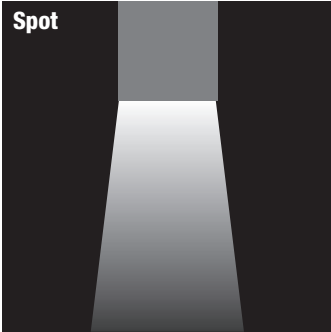
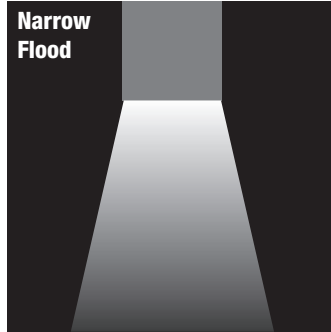
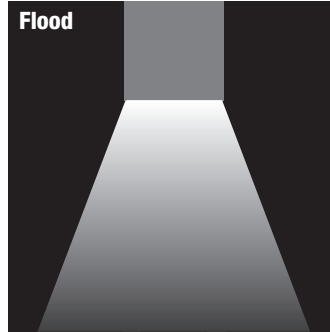
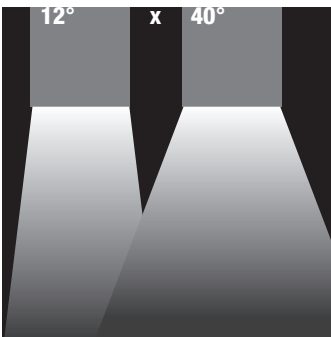
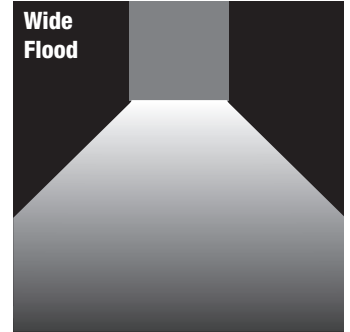
Spot**Narrow Flood****Flood****Wide Flood**

Due to continuous development and improvements, specifications are subject to change without notice. FC Lighting reserves the right to change lab test details or specifications without notice. Product use certifies agreement to FC Lighting terms and conditions. FCC Series Cylinder Lights are engineered and produced in our Illinois manufacturing facility.



US Commercial Lighting Manufacturer Since 1982

Specification Sheet

BATTERY BACK-UPS

BBUR - BATTERY BACK-UP & LED DRIVER REMOTE (INDOOR), IP20, IK08, NEMA 1, 0°C to +48°C, 30' MAX Distance with 12AWG (w/UNV Option Only)

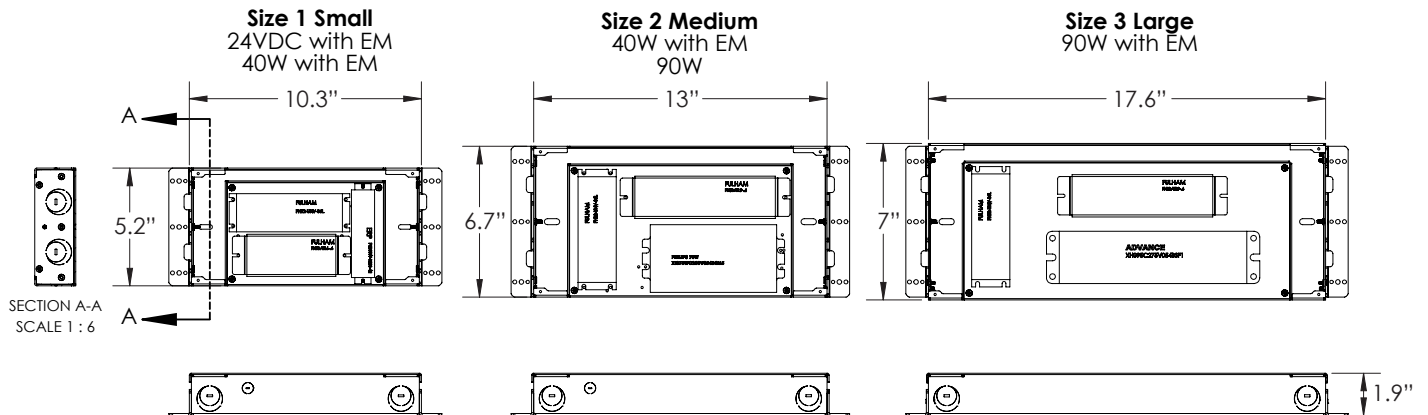

BBUX - BATTERY BACK-UP & LED DRIVER REMOTE (OUTDOOR), IP67, IK10, NEMA 4X, -20°C to +55°C, 30' MAX Distance with 12AWG (w/UNV Option Only)

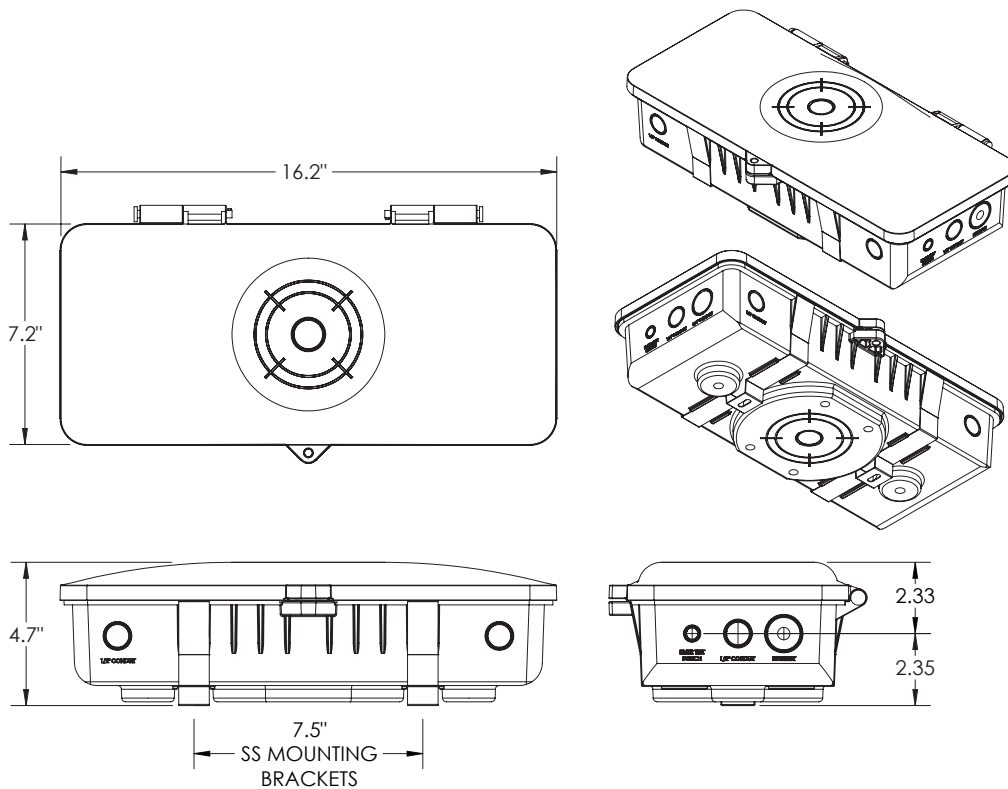

Due to continuous development and improvements, specifications are subject to change without notice. FC Lighting reserves the right to change lab test details or specifications without notice. Product use certifies agreement to FC Lighting terms and conditions. FCC Series Cylinder Lights are engineered and produced in our Illinois manufacturing facility.