



FCW3707p



Date:

Type:

Fixture:

Project:

Approved:

FCW3707p Exterior Decor is a small slim profile, die-cast aluminum 7 inch square fixture and is IP65 rated. This ADA compliant, easy to install fixture has an impact resistant lens and provides ample lighting for ceiling, wall or surface mounting. It offers finish options and color temperatures to support a wider variety of application specifications.

SPECIFICATIONS

EOL

PHYSICAL

lengths/dimensions	fixture: 6.9" Sq x 1.77" D
weight	.5 lbs
housing	marine grade, corrosion resistant, heavy gauge high pressure die cast aluminum
lens	impact and vandal resistant, UV stabilized, white opal, polycarbonate
mounting	ceiling, wall or surface mount applications: mounting holes allow unit to be attached directly to octagonal junction box
ingress protection	IP65 Rated. Suitable for wet, damp or dry location application, with extruded silicone gasket to seal out contaminants
finish	six stage chemical iron phosphate substrate pre-treatment process with UV stable, polyester powder coat

PERFORMANCE

color temperature	2700K	3000K	3500K	4000K	
lumen output	990 lm				
lifetime	> 70,000 hours / L70 or better				
color consistency	3 SDCM / 85CRI optional: 90CRI				
operating temperature	-13°F to 104°F (-25°C to 40°C)				
junction temperature	73°C @ T ^a 25°C				
warranty	5 year limited warranty (refer to website for details)				

ELECTRICAL

input voltage	standard: 120V AC optional: 347V (remote only)
power supply	integral Class II, electronic high-power factor > 94% @120V
certifications	CEC Title 24 JA8 compliant (only 90CRI complies), ADA Compliant
standards	IES LM-79 / LM-80
power consumption	10W @ 120V
dimming interface	optional: ELV (120V only)/DMX (remote only)/DALI (remote only)

Due to continuous development and improvements, specifications are subject to change without notice. FC Lighting reserves the right to change lab test details or specifications without notice. Product use certifies agreement to FC Lighting terms and conditions.

FCW3707p



Ordering Information

ORDERING INFORMATION

FCW3707p											
SERIES		VOLTAGE		CCT		CRI		FINISH		OPTIONS	
FCW3707p		120	120V AC	LED	27K 990 lm (10W)	CRI85	85 CRI	BK	Black	ELV*	ELV Dimming* (120V only)
					3K	CRI90	90 CRI	BZ	Bronze	BBUR	Battery Backup (Remote only)
					35K			CC	Custom Color		
					4K			SL	Silver		* consult factory for lead time
								WH	White		

Due to continuous development and improvements, specifications are subject to change without notice. FC Lighting reserves the right to change lab test details or specifications without notice. Product use certifies agreement to FC Lighting terms and conditions.

 US Commercial Lighting Manufacturer Since 1982

Specification Sheet

© FC Lighting, Inc. 3609 swenson ave • st. charles il • 60174 | fclighting.com | 800.900.1730



Dimensions

PRODUCT DIMENSIONS - STANDARD PRODUCT

width	6.9" W
depth	1.77" D

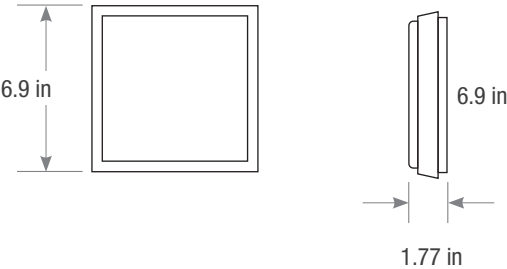

MOUNTING - *j-box sold by others*

mounting plate width	6.5" W
----------------------	--------

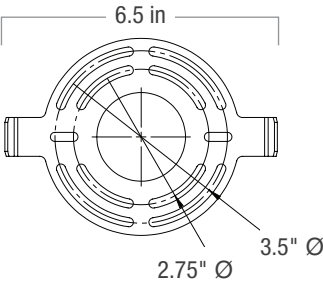

6.5 inch mounting plate:
mounts flush to surface,
included with fixture.

3.5" or 2.75" mounting diameter

Due to continuous development and improvements, specifications are subject to change without notice. FC Lighting reserves the right to change lab test details or specifications without notice. Product use certifies agreement to FC Lighting terms and conditions.



Photometry

OPTICAL DISTRIBUTION

lumen output	990 Lm @ 3000K
power consumption	10W

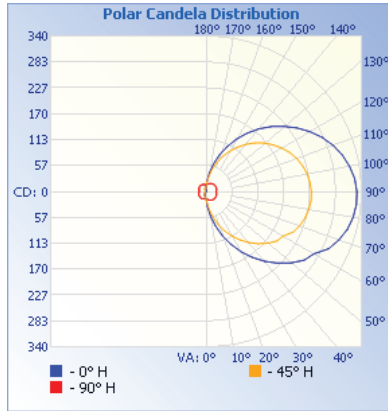
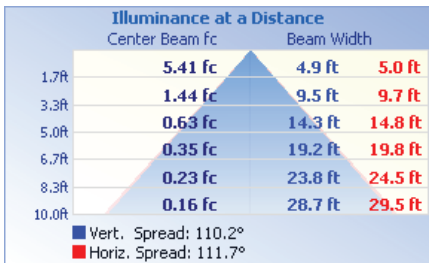

iti illuminations testing laboratory :

FCW3707p

FIND IES FILES ON FCLIGHTING.COM



Due to continuous development and improvements, specifications are subject to change without notice. FC Lighting reserves the right to change lab test details or specifications without notice. Product use certifies agreement to FC Lighting terms and conditions.