

FCSL102



Date:		Approved:
Type:		
Luminaire:		
Project:		

FCSL102 IP65 rated exterior die-cast brick step light with open lens for masonry applications. Corrosion resistant, die-cast aluminum construction, this fixture provides illumination for damp, dry or wet areas.

SPECIFICATIONS

PHYSICAL

dimensions	9.875" W x 3.125" H x 3" D
weight	2 lbs
housing	Marine grade, corrosion resistant, heavy gauge aluminum faceplate
lens	White glass lens
mounting	Concrete pour, masonry applications
ingress protection	IP65: dry, damp or wet locations with extruded silicone gasket to seal out contaminants
faceplate finish	Available in Black, Bronze, Graphite Grey, Silver, White and Custom Colors. Six stage chemical iron phosphate conversion pre-treatment. Polyester powder coat finish, 18 µm minimum, 5,000 hour salt spray test (ASTM B117) compliant with Florida / AAMA 2604 specification.

PERFORMANCE

color temperature	2700K, 3000K, 3500K, 4000K
lumen output	310 lm
lumen maintenance	L70 > 70,000 hours
color consistency	3 SDCM / 85 CRI
warranty	5-Year limited warranty

ELECTRICAL

input voltage	Universal 120 - 277 VAC
power supply	Integral Class II, electronic high-power factor > 94% @ 120V
certifications	ETL / cETL Listed, ADA compliant, IC Rated
standards	UL1598/CSA C22.2 No. 250.0; UL 8750/CSA C22.2 No. 250.13/IES LM-79/LM-80
power consumption	10W @ 120 - 277 VAC
dimming	0-10V (10%)

Due to continuous development and improvements, specifications are subject to change without notice. FC Lighting reserves the right to change lab test details or specifications without notice. Product use certifies agreement to FC terms and conditions.



Ordering Information

PART NUMBER												
FCSL102				CRI85		3L						
SERIES	VOLTAGE		CCT		CRI		LUMENS		FINISH	OPTIONS		
FCSL102	120V	120 VAC	27K	2700K	CRI85	85 CRI	3L	310 lm (10W)	BKE	Black	LD	0-10V Dimming (Standard)
	277V	277 VAC	3K	3000K					BRE	Bronze	HB	Hanger Bracket
	UNV	120 - 277 VAC	35K	3500K					GRE	Graphite Grey	LBB	Less Back Box (for shipment separate of Back Box)
			4K	4000K					SLE	Silver		
									WHE	White		
									CCE	Custom Color		

BACK BOX KITS

- H99001-ETL** Back Box Kit - Complete Back Box shipped in advance of luminaire without mounting kit.
- H99001-ETL-HB** Back Box Kit w/ Hanger Bar - Includes (H99001-ETL) Complete Back Box shipped with mounting kit and Hanger Bar (HB), shipped in advance of luminaire.

Consult Factory for other options and configurations.

To ensure you receive proper configurations for your lighting specifications, contact us directly about any unique application requirements. This may include but not be limited to lumen output, mounting needs, or electrical requirements.

Due to continuous development and improvements, specifications are subject to change without notice. FC Lighting reserves the right to change lab test details or specifications without notice. Product use certifies agreement to FC terms and conditions.

US Commercial Lighting Manufacturer Since 1982

© FC Lighting 3609 Swenson Ave. • St. Charles, IL • 60174 | fcighting.com | 800.900.1730

Specification Sheet

TG-DM-041326



Dimensions

PRODUCT DIMENSIONS - STANDARD PRODUCT

width	9.875" W
height	3.125" H
depth	3" D

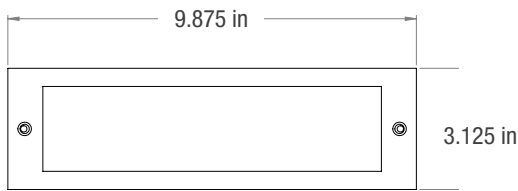
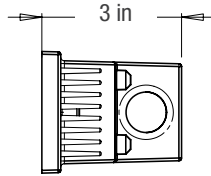

MOUNTING - *j-box sold by others*

back box width	9.375" W
back box height	2.64" H
back box depth	3" D

back box mounts inside brick masonry: faceplate flush to surface or in front of surface - see installation instructions for proper mounting directions

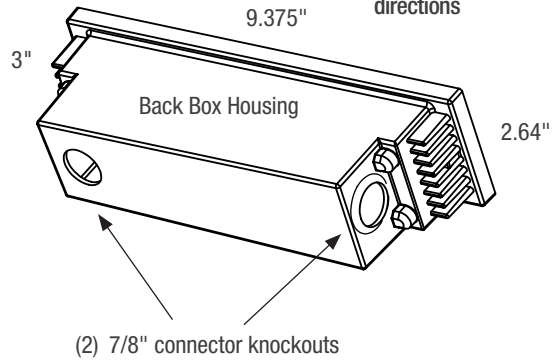

Due to continuous development and improvements, specifications are subject to change without notice. FC Lighting reserves the right to change lab test details or specifications without notice. Product use certifies agreement to FC terms and conditions.



Photometry

OPTICAL DISTRIBUTION

lumen output	311 lm @ 4000K
power consumption	10W

Illuminance at a Distance			
	Center Beam fc	Beam Width	
1.7R	0.27 fc	4.4 ft	4.9 ft
3.3R	0.07 fc	8.6 ft	9.6 ft
5.0R	0.03 fc	13.0 ft	14.5 ft
6.7R	0.02 fc	17.4 ft	19.4 ft
8.3R	0.01 fc	21.5 ft	24.0 ft
10.0R	0.01 fc	25.9 ft	29.0 ft

■ Vert. Spread: 104.7°
■ Horiz. Spread: 110.8°

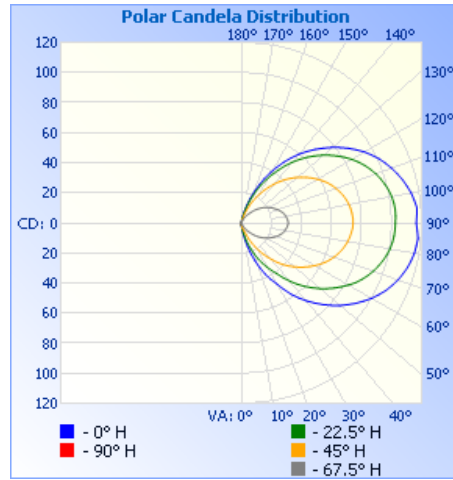

iti illuminations testing laboratory: Report #2035

Due to continuous development and improvements, specifications are subject to change without notice. FC Lighting reserves the right to change lab test details or specifications without notice. Product use certifies agreement to FC terms and conditions.

 US Commercial Lighting Manufacturer Since 1982