

FCSL105



FCSL105 IP65 rated exterior die-cast brick step light with louvered faceplate for masonry applications. Corrosion resistant, die-cast aluminum construction, this fixture provides illumination for damp, dry or wet areas.



SPECIFICATIONS

PHYSICAL	
lengths/dimensions	9.5" W x 2.8125" H x 3" Deep
weight	2 lbs
housing	Marine grade, corrosion resistant, heavy gauge aluminum louvered faceplate
lens	White glass lens
mounting	Concrete pour, masonry applications
ingress protection	IP65 : dry, damp or wet locations with extruded silicone gasket to seal out contaminants
faceplate finish	Six stage chemical iron phosphate conversion pre-treatment. Polyester powder coat finish, 18 µm Min., 5000hr salt spray test (ASTM B117) compliant with Florida / AAMA 2604 specification.

PERFORMANCE				
color temperature	2700K	3000K	3500K	4000K
lumen output	190 lm			
lifetime	> 70,000 hours / L70 or better			
color consistency	3 SDCM / 85 CRI			
operating temperature	-13°F to 104°F (-25°C to 40°C)			
junction temperature	73°C @ T ^a 25°C			
warranty	5-Year limited warranty (refer to website for details)			

ELECTRICAL	
input voltage	Universal 120 - 277 VAC
power supply	Integral Class II, electronic high-power factor > 94% @ 120V
certifications	ETL / cETL Listed ADA compliant BUG Rating: B0-U0-G0
standards	UL1598/CSA C22.2 No. 250.0; UL 8750/CSA C22.2 No. 250.13/IES LM-79/LM-80
power consumption	10W @ 190 lumens
dimming	0-10V (10%)

Due to continuous development and improvements, specifications are subject to change without notice. FC Lighting reserves the right to change lab test details or specifications without notice. Product use certifies agreement to FC terms and conditions.



Ordering Information

ORDERING INFORMATION

FCSL105					CRI85	2L						
SERIES	VOLTAGE		CCT		CRI		LUMENS		FINISH		OPTIONS	
FCSL105	120V	120 VAC	27K	2700K	CRI85	85 CRI	2L	190 lm (10W)	BKE	Black	LD	0-10V Dimming (Standard)
	277V	277 VAC	3K	3000K					BRE	Bronze	HB	Hanger Bracket
	UNV	120 - 277 VAC	35K	3500K					GRE	Graphite Grey	LBB	Less Back Box (for shipment separate of Back Box)
			4K	4000K					SLE	Silver		
								WHE	White			
									CCE	Custom Color		

BACK BOX KITS

H99001-ETL Back Box Kit - Complete Back Box shipped in advance of fixture without mounting kit.

REMOTE DRIVER & BATTERY BACKUP

FCSL105R	UNV				CRI85	2L						
SERIES	VOLTAGE		CCT		CRI		LUMENS		FINISH		OPTIONS	
FCSL105R [†]	UNV	120 - 277 VAC	27K	2700K	CRI85	85 CRI	2L	190 lm (10W)	BKE	Black	LD	0-10V Dimming (Standard)
			3K	3000K					BRE	Bronze	HB	Hanger Bracket
			35K	3500K					GRE	Graphite Grey	LBB	Less Back Box (for shipment separate of Back Box)
			4K	4000K					SLE	Silver		
								WHE	White	BBUR ¹	Battery Backup Remote (Indoor)	
								CCE	Custom Color	BBUX ²	Battery Backup Remote (Outdoor)	
										N/A	(Leave Blank for Remote Driver Only without Battery Backup)	

[†] LED DRIVER REMOTE (INDOOR) IP20, IK08, NEMA 1, -20°C to +50°C, 30' MAX Distance with 12AWG.
*Consult factory for outdoor remote driver only.

¹ Battery Back-up & LED Driver Remote (INDOOR), IP20, IK08, NEMA 1, 0°C to +48°C, 30' MAX Distance with 12AWG (w/UNV Option Only)
² Battery Back-up & LED Driver Remote (OUTDOOR), IP67, IK10, NEMA 4X, -20°C to +55°C, 30' MAX Distance with 12AWG (w/UNV Option Only)

Consult Factory for other options and configurations.

To ensure you receive proper configurations for your lighting specifications, contact us directly about any unique application requirements. This may include but not be limited to lumen output, mounting needs, or electrical requirements.

Due to continuous development and improvements, specifications are subject to change without notice. FC Lighting reserves the right to change lab test details or specifications without notice. Product use certifies agreement to FC terms and conditions.



Dimensions

PRODUCT DIMENSIONS - STANDARD PRODUCT

width	9.5" W
height	2.8125" H
depth	3" D

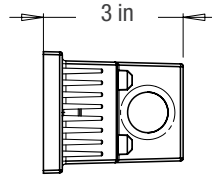
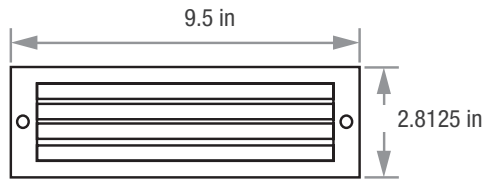

MOUNTING - j-box sold by others

back box width	9.375" W
back box height	2.64" H
back box depth	3" D

back box mounts inside brick masonry: faceplate flush to surface or in front of surface - see installation instructions for proper mounting directions

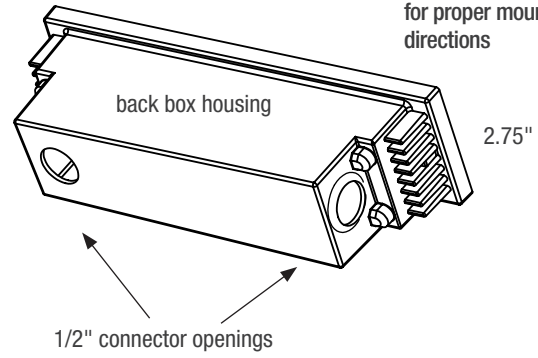

Due to continuous development and improvements, specifications are subject to change without notice. FC Lighting reserves the right to change lab test details or specifications without notice. Product use certifies agreement to FC terms and conditions.



Photometry

OPTICAL DISTRIBUTION

lumen output	188 Lm @ 4000K
power consumption	10W

Illuminance at a Distance			
	Center Beam fc	Beam Width	
1.7R	1.94 fc	0.5 ft	1.4 ft
3.3R	0.52 fc	0.9 ft	2.7 ft
5.0R	0.22 fc	1.4 ft	4.1 ft
6.7R	0.12 fc	1.8 ft	5.5 ft
8.3R	0.08 fc	2.3 ft	6.9 ft
10.0R	0.06 fc	2.7 ft	8.3 ft

■ Vert. Spread: 15.5°
■ Horiz. Spread: 44.9°

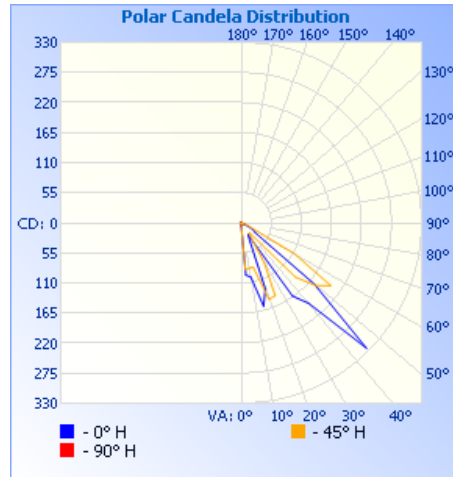

iti illuminations testing laboratory: Report #2014

Due to continuous development and improvements, specifications are subject to change without notice. FC Lighting reserves the right to change lab test details or specifications without notice. Product use certifies agreement to FC terms and conditions.

 US Commercial Lighting Manufacturer Since 1982

Specification Sheet

BATTERY BACK-UPS

BBUR - BATTERY BACK-UP & LED DRIVER REMOTE (INDOOR), IP20, IK08, NEMA 1, 0°C to +48°C, 30' MAX Distance with 12AWG (w/UNV Option Only)

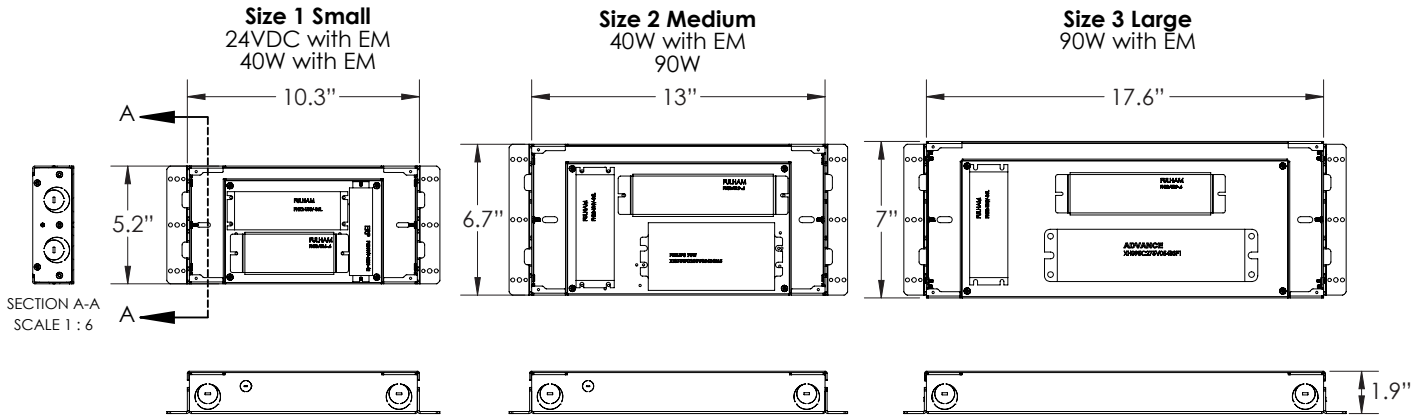

BBUX - BATTERY BACK-UP & LED DRIVER REMOTE (OUTDOOR), IP67, IK10, NEMA 4X, -20°C to +55°C, 30' MAX Distance with 12AWG (w/UNV Option Only)

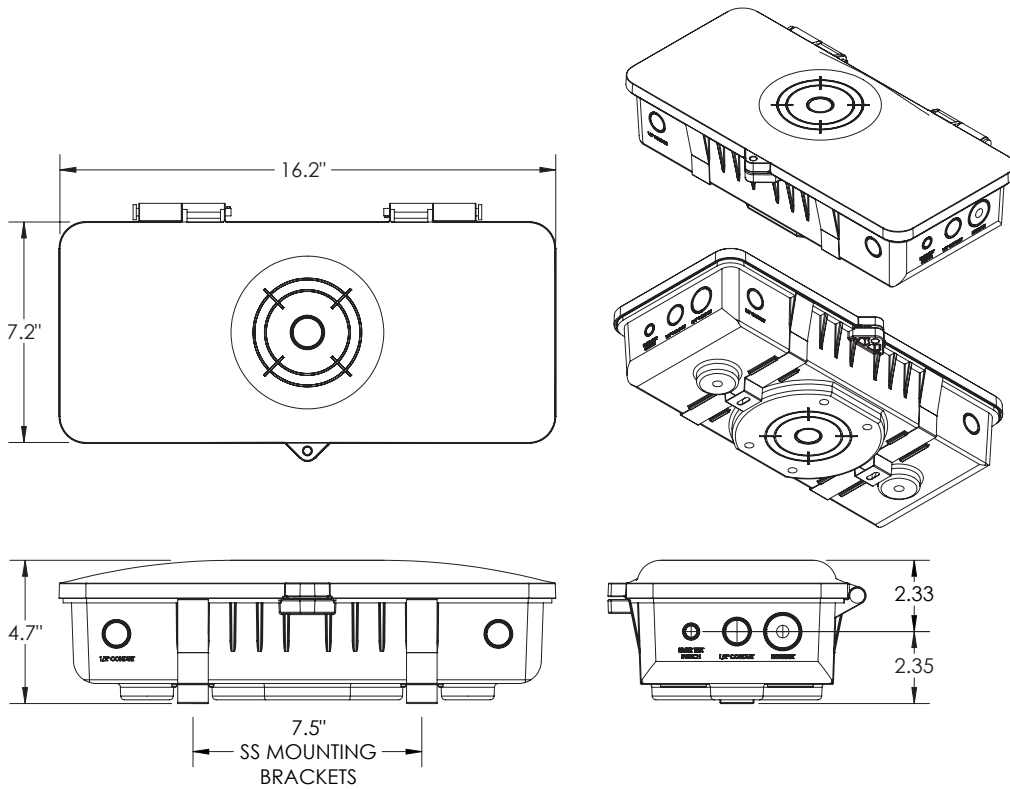

Due to continuous development and improvements, specifications are subject to change without notice. FC Lighting reserves the right to change lab test details or specifications without notice. Product use certifies agreement to FC terms and conditions.