

Date:	Approved:
Type:	
Luminaire:	
Project:	

FCSL108



FCSL108 IP65 rated exterior stainless steel brick step light with open lens for masonry applications. Corrosion resistant, die-cast aluminum housing construction, this luminaire provides illumination for damp, dry or wet areas.



SPECIFICATIONS

PHYSICAL	
lengths/dimensions	9.5" W x 2.83" H x 3" D
weight	2 lbs
housing	Marine grade, corrosion resistant, stainless steel
lens	White glass lens
mounting	Concrete pour, masonry applications
ingress protection	IP65: Dry, damp or wet locations with extruded silicone gasket to seal out contaminants
faceplate finish	Marine grade stainless steel

PERFORMANCE	
color temperature	2700K, 3000K, 3500K, 4000K
lumen output	340 lm with white lens
lumen maintenance	L70 > 70,000 hours
color consistency	3 SDCM / 85 CRI
warranty	5-Year limited warranty

ELECTRICAL	
input voltage	Universal 120–277 VAC
power supply	Integral Class II, electronic high-power factor > 94% @ 120V
certifications	ETL / cETL Listed, ADA Compliant, IC Rated
standards	UL1598/CSA C22.2 No. 250.0; UL 8750/CSA C22.2 No. 250.13/IES LM-79/LM-80
power consumption	10W @ 120 - 277 VAC
dimming	0-10V (10%)

Due to continuous development and improvements, specifications are subject to change without notice. FC Lighting reserves the right to change lab test details or specifications without notice. Product use certifies agreement to FC terms and conditions.

 US Commercial Lighting Manufacturer Since 1982



Ordering Information

PART NUMBER												
FCSL108				CRI85		3L		SS				
SERIES	VOLTAGE		CCT		CRI		LUMENS		FINISH		OPTIONS	
FCSL108	120V	120 VAC	27K	2700K	CRI85	85 CRI	3L	340 lm (10W)	SS	Stainless Steel	LD	0-10V Dimming (Standard)
	277V	277 VAC	3K	3000K							HB	Hanger Bracket
	UNV	120 - 277 VAC	35K	3500K							LBB	Less Back Box (for shipment separate of Back Box)
			4K	4000K								

BACK BOX KITS	
---------------	--

- H99001-ETL** Back Box Kit - Complete Back Box shipped in advance of luminaire without mounting kit.
- H99001-ETL-HB** Back Box Kit w/ Hanger Bar - Includes (H99001-ETL) Complete Back Box shipped with mounting kit and Hanger Bar (HB), shipped in advance of luminaire.

Consult Factory for other options and configurations.

To ensure you receive proper configurations for your lighting specifications, contact us directly about any unique application requirements. This may include but not be limited to lumen output, mounting needs, or electrical requirements.

Due to continuous development and improvements, specifications are subject to change without notice. FC Lighting reserves the right to change lab test details or specifications without notice. Product use certifies agreement to FC terms and conditions.

 US Commercial Lighting Manufacturer Since 1982

© FC Lighting 3609 Swenson Ave. • St. Charles, IL • 60174 | fcighting.com | 800.900.1730

Specification Sheet

TG-DM-041326



Dimensions

PRODUCT DIMENSIONS - STANDARD PRODUCT

width	9.5" W
height	2.83" H
depth	3" D

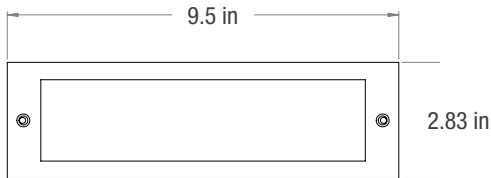
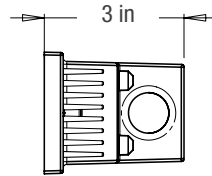

MOUNTING - *j-box sold by others*

back box width	9.375" W
back box height	2.64" H
back box depth	3" D

back box mounts inside brick masonry: faceplate flush to surface or in front of surface - see installation instructions for proper mounting directions

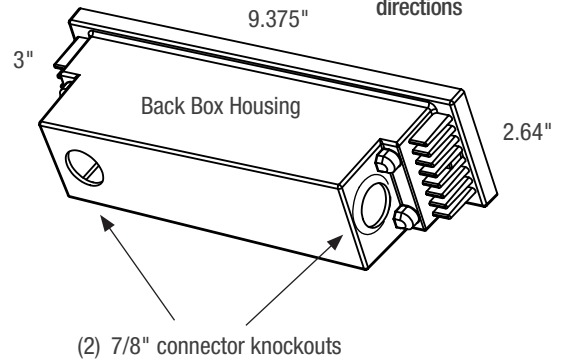

Due to continuous development and improvements, specifications are subject to change without notice. FC Lighting reserves the right to change lab test details or specifications without notice. Product use certifies agreement to FC terms and conditions.



Photometry

OPTICAL DISTRIBUTION

lumen output	341 lm @ 4000K
power consumption	10W
lens	opal glass

illuminations testing labroatory: Report #2037

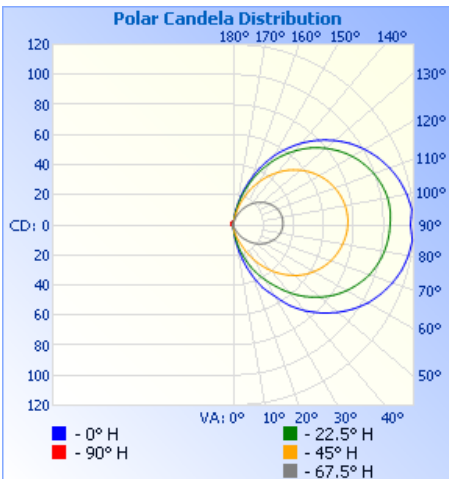

Illuminance at a Distance

	Center Beam fc	Beam Width	
1.7R	0.12 fc	5.2 ft	5.1 ft
3.3R	0.03 fc	10.1 ft	9.8 ft
5.0R	0.01 fc	15.3 ft	14.9 ft
6.7R	0.01 fc	20.5 ft	19.9 ft
8.3R	0.01 fc	25.4 ft	24.7 ft
10.0R	0.00 fc	30.6 ft	29.7 ft

■ Vert. Spread: 113.6°
■ Horiz. Spread: 112.2°

Due to continuous development and improvements, specifications are subject to change without notice. FC Lighting reserves the right to change lab test details or specifications without notice. Product use certifies agreement to FC terms and conditions.

US Commercial Lighting Manufacturer Since 1982