

Date: _____

Type: _____

Fixture: _____

Project: _____

Approved:

FCW1029

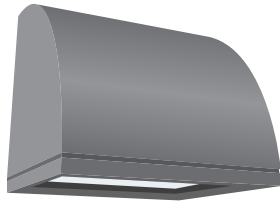

FCW1029 Architectural pyramid design, Directional Wall Luminaire is a functional IP65 rated down light. Corrosion resistant, extruded aluminum construction, this luminaire provides ample illumination for damp, dry or wet areas.



SPECIFICATIONS

PHYSICAL

beam patterns	Spot, Narrow Flood, Flood, Wide Flood, Ellipsoidal (12 x 40), Asymmetric
dimensions	12" W x 12" H x 12" D
weight	10 lbs
housing	Marine grade, corrosion resistant, heavy gauge aluminum
lens	Standard: 1/8" thick, clear tempered glass lens, Optional: polycarbonate lens
mounting	Mounts directly to standard junction box; masonry applications use four (4) 0.25" x 0.75" screws with lead anchors (fasteners not included, j-box by others), Optional: adjustable arm (15° tilt)
ingress protection	IP65 : dry, damp or wet locations with extruded silicone gasket to seal out contaminants
finish	Available in Black, Bronze, Graphite Grey, Silver, White and Custom Colors. Six stage chemical iron phosphate conversion pre-treatment. Polyester powder coat finish, 18 µm minimum, 5,000 hour salt spray test (ASTM B117) compliant with Florida / AAMA 2604 specification.

PERFORMANCE

color temperature	2700K, 3000K, 3500K, 4000K
lumen output	1000 lm, 1500 lm, 2000 lm, 2500 lm, 3000 lm
lumen maintenance	L70 > 70,000 hours
color consistency	3 SDCM / standard: 85 CRI, optional: 90 CRI
operating temperature	-13°F to 104°F (-25°C to 40°C)
warranty	5-Year limited warranty

ELECTRICAL

input voltage	Universal 120 - 277 VAC, optional: 347 VAC (integral)
power supply	Integral Class II, electronic, high power factor > 94% @ 120V
certifications	ETL/cETL Listed, CEC Title 24 JA8 compliant (only 90CRI qualifies)
standards	UL1598/CSA C22.2 No. 250.0; UI 8750/CSA C22.2 No. 250.13/IES LM-79/LM-80
power consumption	40W @ 120 - 277 VAC
dimming	standard: 0-10V (1%), optional: ELV (120V Only) / DMX (integral) / DALI (integral)

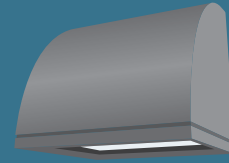

Ordering Information

ORDERING INFORMATION

SERIES	VOLTAGE	CCT	CRI	LUMENS	FINISH	OPTICS	OPTIONS
FCW1029	UNV 120 - 277 VAC	27K 2700K	CRI85 85 CRI (Standard)	10L 1000 lm (13W)	BKE Black	SP Spot	LD 0-10V Dimming (1%) (Standard)
	120V 120 VAC	3K 3000K	CRI90 90 CRI	15L 1500 lm (20W)	BRE Bronze	NFL Narrow Flood	ELV* ELV Dimming *(120 VAC Only)
	347V 347 VAC (Integral)	35K 3500K		20L 2000 lm (27W)	GRE Graphite Grey	FL Flood	DMX DMX Dimming (Integral)
		4K 4000K		25L 2500 lm (34W)	SLE Silver	WFL Wide Flood	DALI DALI Dimming (Integral)
				30L 3000 lm (40W)	WHE White	1240 12°x40° Ellipsoidal	PCL Polycarbonate Lens
					CCE Custom Color	ASYM Asymmetrical	ADJ Adjustable Arm, 15° tilt
							BBUR Battery Backup, Remote

REMOTE DRIVER & BATTERY BACKUP

SERIES	VOLTAGE	CCT	CRI	LUMENS	FINISH	OPTICS	OPTIONS
FCW1029R[†]	UNV 120 - 277 VAC	27K 2700K	CRI85 85 CRI (Standard)	10L 1000 lm (13W)	BKE Black	SP Spot	LD 0-10V Dimming (1%) (Standard)
		3K 3000K	CRI90 90 CRI	15L 1500 lm (20W)	BRE Bronze	NFL Narrow Flood	DMX DMX Dimming (Remote)
		35K 3500K		20L 2000 lm (27W)	GRE Graphite Grey	FL Flood	DALI DALI Dimming (Remote)
		4K 4000K		25L 2500 lm (34W)	SLE Silver	WFL Wide Flood	PCL Polycarbonate Lens
				30L 3000 lm (40W)	WHE White	1240 12°x40° Ellipsoidal	ADJ Adjustable Arm, 15° tilt
					CCE Custom Color	ASYM Asymmetrical	BBUR¹ Battery Backup Remote (Indoor)
							BBUX² Battery Backup Remote (Outdoor)
							N/A Leave Blank for Remote Driver Only (without Battery Backup)

[†] LED DRIVER REMOTE (INDOOR) IP20, IK08, NEMA 1, -20°C to +50°C, 30' MAX Distance with 12AWG.

*Consult factory for outdoor remote driver only.

¹ Battery Back-up & LED Driver Remote (INDOOR), IP20, IK08, NEMA 1, 0°C to +48°C, 30' MAX Distance with 12AWG (w/UNV Option Only)

² Battery Back-up & LED Driver Remote (OUTDOOR), IP67, IK10, NEMA 4X, -20°C to +55°C, 30' MAX Distance with 12AWG (w/UNV Option Only)



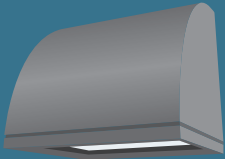

Dimensions

PRODUCT DIMENSIONS - STANDARD PRODUCT

width	12" W
height	12.06" H
depth	12.06" D

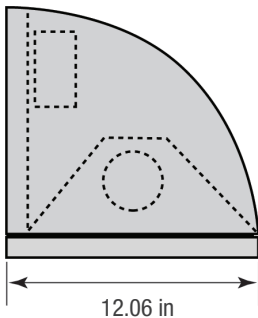
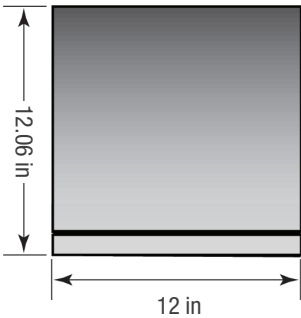

MOUNTING - *j-box sold by others*

mounting cleat width	4" W
mounting cleat height	10" H

mounting cleat:
mounts flush to j-box
surface and is included
with luminaire

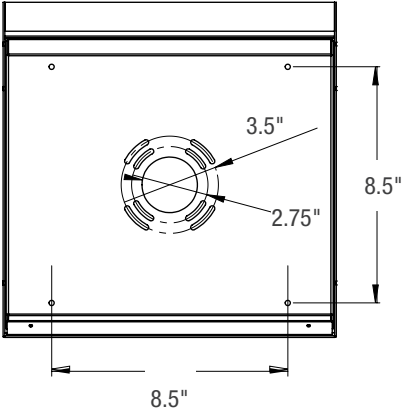

3.5" or 2.75" mounting diameter

Due to continuous development and improvements, specifications are subject to change without notice.
Product use certifies agreement to FC Lighting, Inc. terms and conditions.

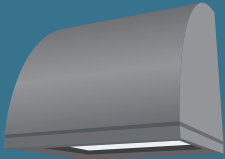

Photometry

FCW1029

FIND IES FILES ON FCLIGHTING.COM

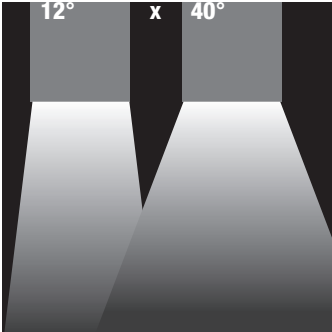
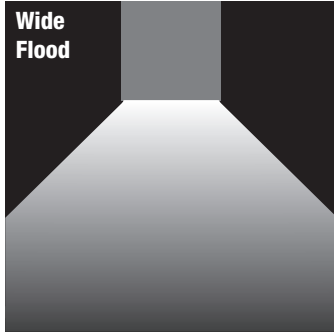
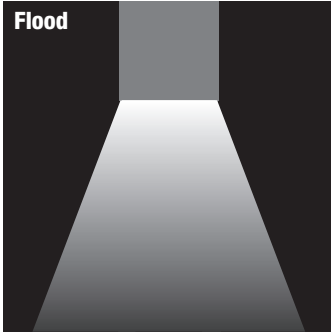
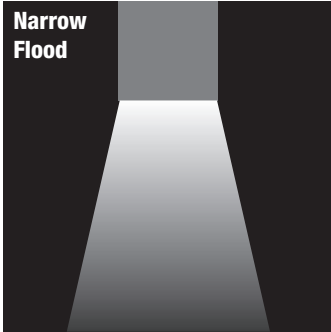
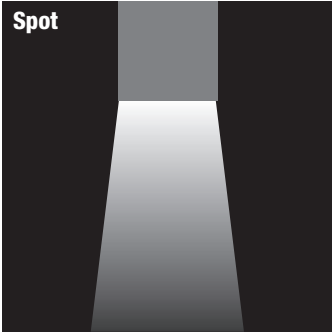

Due to continuous development and improvements, specifications are subject to change without notice.
Product use certifies agreement to FC Lighting, Inc. terms and conditions.

BATTERY BACK-UPS

BBUR - BATTERY BACK-UP & LED DRIVER REMOTE (INDOOR), IP20, IK08, NEMA 1, 0°C to +48°C, 30' MAX Distance with 12AWG (w/UNV Option Only)

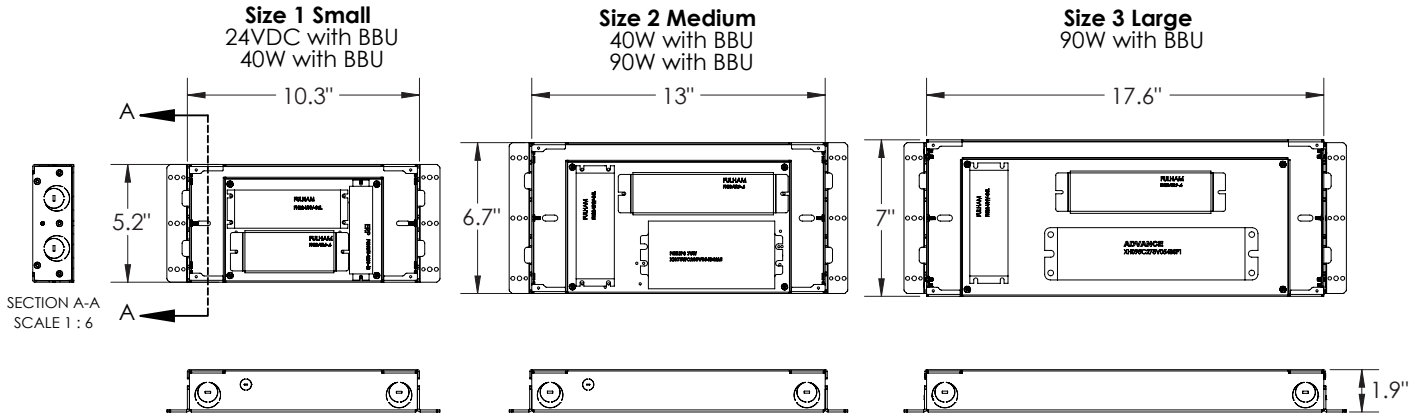

BBUX - BATTERY BACK-UP & LED DRIVER REMOTE (OUTDOOR), IP67, IK10, NEMA 4X, -20°C to +55°C, 30' MAX Distance with 12AWG (w/UNV Option Only)

