

FCWA AUREA Luminaire — INSTALLATION INSTRUCTIONS

CAUTION: BEFORE CONNECTING THE LUMINAIRE TO A POWER SUPPLY, MAKE SURE THE POWER IS SWITCHED OFF.

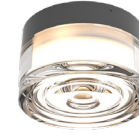

† 800.900.1730
3609 Swenson Ave.
St. Charles, IL 60174

GENERAL:

1. Luminaire must be installed by a licensed electrician.
2. All electrical connections must be in accordance with local codes, ordinances, or the National Electrical Code.
3. Before starting the installation, make sure all electricity has been turned off and electrical breaker has been locked out and tagged out.
4. To ensure the success of the installation, be sure to read these instructions and review the diagrams thoroughly before beginning.

NOTE: The important safeguards and instructions appearing in this manual are not meant to cover all possible conditions and situations that may occur.

INSTALLATION INSTRUCTIONS:

1. If using a JBOX, secure the mounting plate to the jbox using the provided 8-32 flathead screws. Tighten to 15 in-lbs. **FIGURE 1A.**
 - a. If mounting directly to a surface instead of a JBOX, use appropriate #8 flathead screws and anchors as necessary. (Not provided)
 - b. **COSMETIC NOTE:** Use the diagram in **FIGURE 1B** to predetermine where the visible locking screw on the exterior housing will be located.
2. Separate the backplate from the main housing by rotating the main housing counter-clockwise. **FIGURE 2A.**
 - a. **NOTE:** It is recommended to change the CCT during this step by adjusting the switch on the backside of the main housing as seen in **FIGURE 2B.**
3. Prior to affixing the backplate, connect the VAC wires on the back of the backplate to the circuit. **FIGURE 3.** Feed the wire splices back into the junction box.
 - i. BLACK = LINE
 - ii. WHITE = NEUTRAL
 - iii. GREEN = GROUND

DETAILED ILLUSTRATION

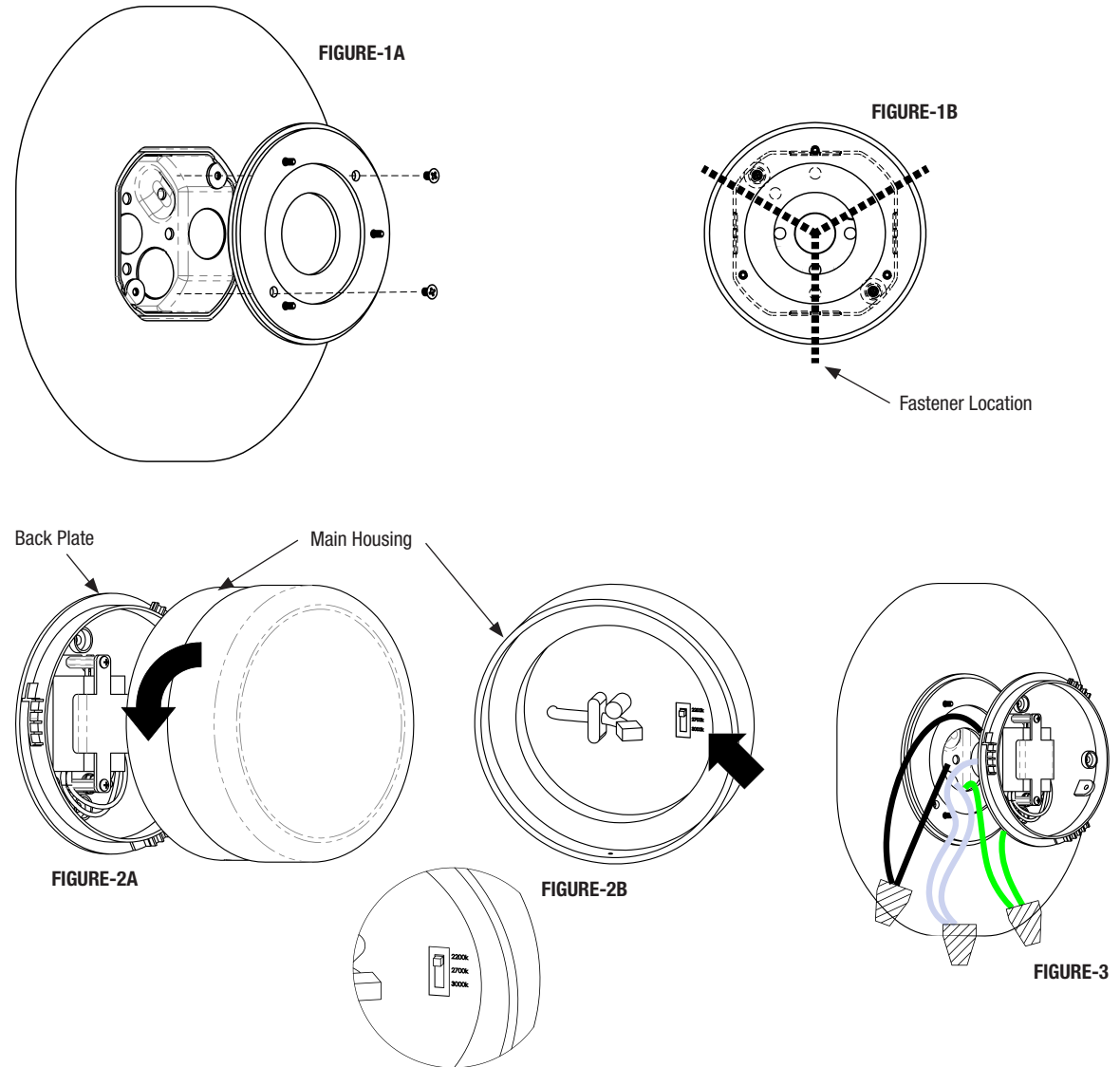

FCWA AUREA Luminaire — INSTALLATION INSTRUCTIONS

CAUTION: BEFORE CONNECTING THE LUMINAIRE TO A POWER SUPPLY, MAKE SURE THE POWER IS SWITCHED OFF.

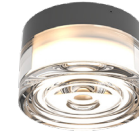

t 800.900.1730
3609 Swenson Ave.
St. Charles, IL 60174

GENERAL:

1. Luminaire must be installed by a licensed electrician.
2. All electrical connections must be in accordance with local codes, ordinances, or the National Electrical Code.
3. Before starting the installation, make sure all electricity has been turned off and electrical breaker has been locked out and tagged out.
4. To ensure the success of the installation, be sure to read these instructions and review the diagrams thoroughly before beginning.

NOTE: The important safeguards and instructions appearing in this manual are not meant to cover all possible conditions and situations that may occur.

INSTALLATION INSTRUCTIONS:

4. Use provided hardware to fasten the backplate to the mounting plate. Tighten the nut to 15 in-lbs. **FIGURE 4A.**

a. **NOTE: The order of hardware (from top to bottom). Figure 4B.**

- i. Plastic sealing washer
- ii. Stainless steel washer
- iii. 6-32 Stainless steel nut.

5. Apply a bead of RTV silicone along the edge of the luminaire.

Warning: Failure to do so can result in water ingress into conduit system. **Figure 5.**

6. Feed the lanyard through the decorative sleeve and attach it to the connection tab as highlighted in **FIGURE 6**. Once connected, feed the VDC wires through the sleeve as well and connect the electronics on the backplate to the main housing.

DETAILED ILLUSTRATION

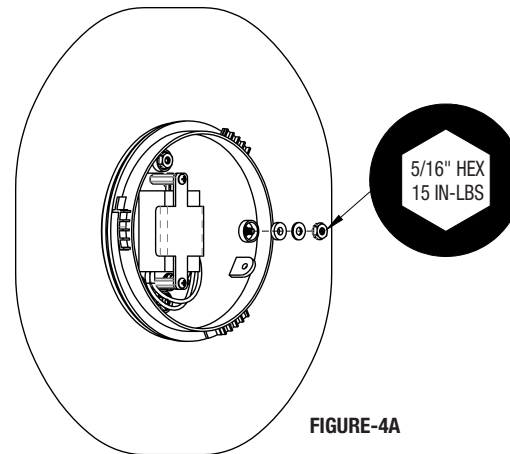

FIGURE-4A

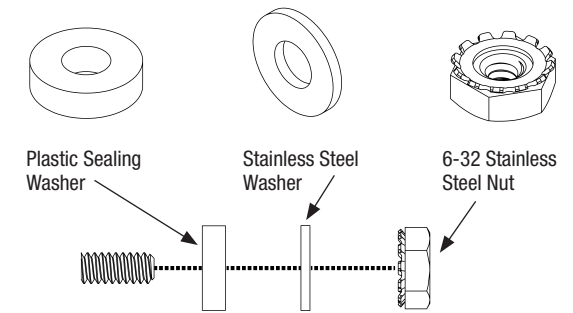

FIGURE-4B

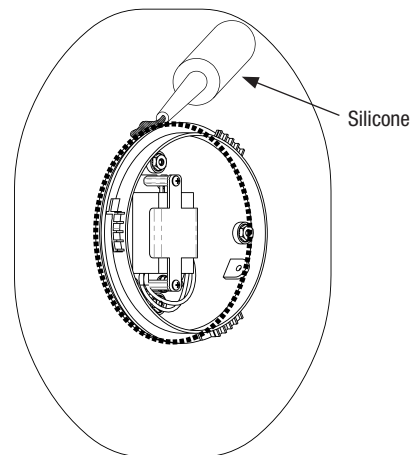
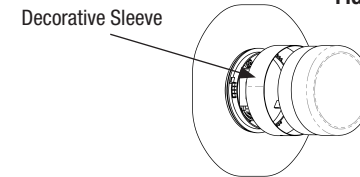

FIGURE-5

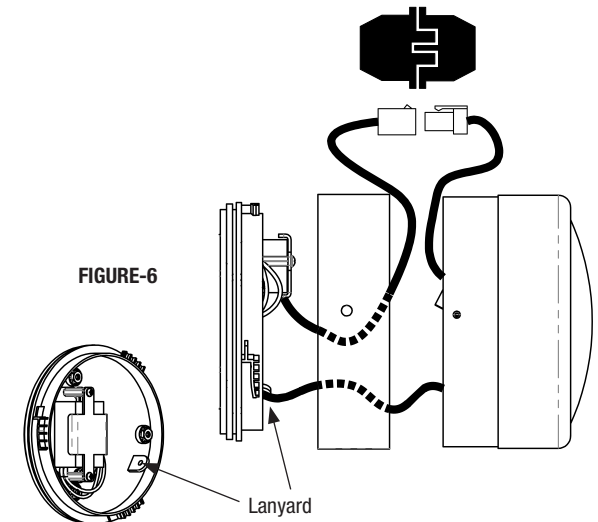
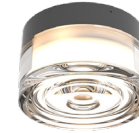

FIGURE-6

FCWA AUREA Luminaire — INSTALLATION INSTRUCTIONS

CAUTION: BEFORE CONNECTING THE LUMINAIRE TO A POWER SUPPLY, MAKE SURE THE POWER IS SWITCHED OFF.



FC 
OUTDOOR LIGHTING

t 800.900.1730
3609 Swenson Ave.
St. Charles, IL 60174

GENERAL:

1. Luminaire must be installed by a licensed electrician.
2. All electrical connections must be in accordance with local codes, ordinances, or the National Electrical Code.
3. Before starting the installation, make sure all electricity has been turned off and electrical breaker has been locked out and tagged out.
4. To ensure the success of the installation, be sure to read these instructions and review the diagrams thoroughly before beginning.

NOTE: The important safeguards and instructions appearing in this manual are not meant to cover all possible conditions and situations that may occur.

INSTALLATION INSTRUCTIONS:

7. Secure the luminaire by firmly grasping the luminaire and rotating clockwise. The luminaire is a twist-lock design. It is recommended to push and rotate luminaire to ensure proper locking. **FIGURE 7.**
8. Rotate decorative sleeve until hole on exterior of sleeve aligns with hole on main hous.
9. Lock the luminaire into place using the provided M2.5 x 5mm screw.

DETAILED ILLUSTRATION

